PROJECT NAME:

Green Ridge Primary Academy

LOCATION:

Aylesbury

M&E ORDER VALUE:

£1.78m

CONTRACTOR:

Kier Southern

M&E DESIGN AND BUILD:

Dodd Group

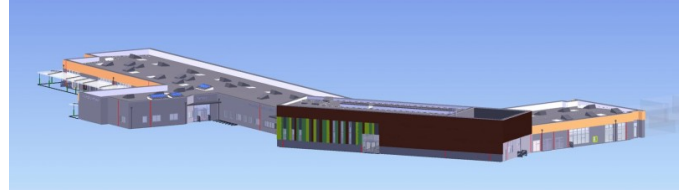

Northampton Office has been successful in securing the Design and Build contract of Green Ridge Primary Academy in Aylesbury, Oxfordshire.

The £1.78M MEPH project has been internally designed by our engineers whilst outsourcing the Building Information Model to Anderson Green of Nottingham.

The Engineers at Northampton are trialling BIM Verification Reporting ensuring that the building installations are measured regularly and are kept within the tolerances of the model using an A360 application. By regularly verifying the BIM and updating it as necessary throughout the construction phase whilst incorporating the non-graphical data into the model should assist with an easier flow of handover documentation required under the contract.

The 2FE school is being designed and built to accommodate an extension for a 3FE school in the near future.

As part of the design requirements, the school will benefit from having an Underfloor Heating Installation throughout, Naturally Ventilated Roof Units, Full Daylight Dimmable LED Lighting and 38 KWp Roof Array of Photovoltaic Panels.